

Usher





She Lives in Luxury...

Usher is the ultimate sport yacht graced with a refined elegance. Like a private retreat on the water, she boasts vast outdoor spaces, an exquisite beach club and an unrivalled audio/visual system that makes her perfectly suited for entertaining family or friends.

Built in the United States by the esteemed Delta yard, Usher's semi-displacement hull and shallow draft allow her to travel with both agility and speed and to explore out of the way locations others cannot go. While her sleek lines and impressive maximum speed of 24 knots evoke an adventuresome demeanor, Usher's lavishly detailed interiors induce a sense of leisure and relaxation. US flagged, she is the ideal yacht for charter cruises in New England, New York and Florida.

HER **DRAMATIC VISUAL PROFILE** IS THE PERFECT UNION OF **STYLISH NAVAL ARCHITECTURE** CRAFTED WITH PERSONALITY AND PRECISION







Fast. Playful. Sophisticated. Adventurous.

When it comes to enjoying the seas, Usher embodies her American builder's spirit of ingenuity and adventure and offers activities to suit all preferences. Usher's two tenders - which include a 56-foot Hampton - towed inflatables, snorkel gear and kayaks invite exploration and fun on the water. Fishing enthusiasts will love the main deck cockpit, which features a live bait well and rod locker, and brand new flyrods will delight the most experienced fly fisherman. A unique hydraulic swim ladder enables guests to enter and exit the water with ease while an underwater camera captures deep-sea curiosities in real-time and broadcasts the live action to guests that prefer to partake of the ocean exploration from the comfort of the yacht's spacious interior.



**A SENSE OF
ADVENTURE
WRAPPED IN
AN ELEGANT
PACKAGE**





Entertaining

Entertaining is what Usher does best. An extensive refit has fitted her with a state-of-the-art Savant Sound entertainment system, easily managed by mini iPads and able to access the ultimate library of movies, music and television shows. Guests can relax in the sun deck hot tub while viewing the brand new 50-inch flatscreen, or sip a drink at the wet bar, which includes one of two onboard margarita machines. Infrared heat panels allow guests to enjoy al fresco dinners on the exterior decks in comfort during those cool New England summer evenings. Dining is a true delight with a top chef aboard. Usher's chef Jon Walter sources only the best local ingredients, while also providing the best provisions from around the world.

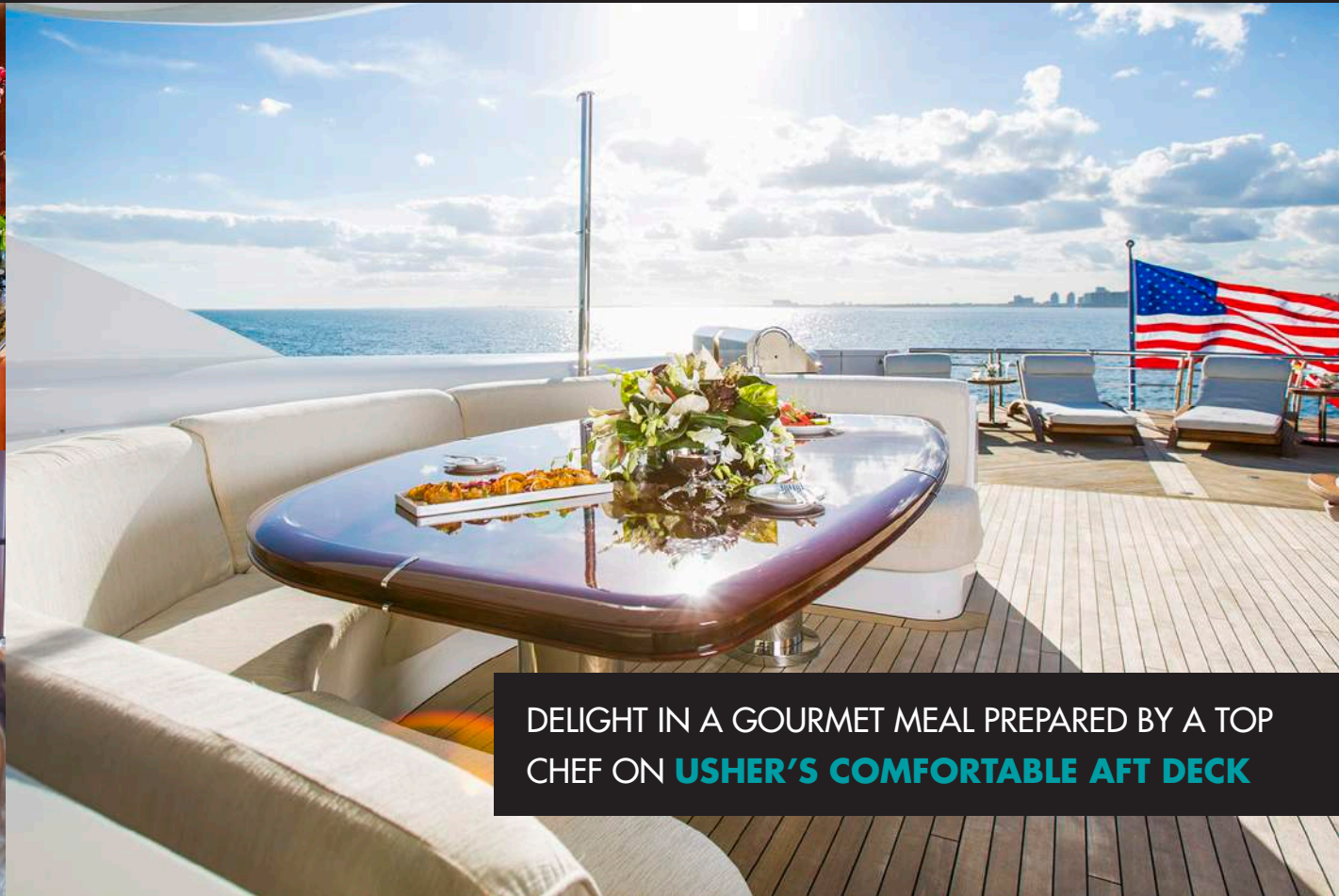

DELIGHT IN A GOURMET MEAL PREPARED BY A TOP CHEF ON **USHER'S COMFORTABLE AFT DECK**



Polynesian Elegance

Venture within Usher's interior and you will be transported to a paradise of coconut trees, coral reefs and shady palms. Her floorplan provides an open, airy and light atmosphere. Splashes of color are infused in the hand-carved floral inlay and fine upholstery of the main salon. Usher embodies a style of Polynesian artistry reinvented, imbued with elegant art deco touches, rich exotic woods of bubinga, wenge and koa, vibrant tropical glasswork and intricate details. Her focal point is the dazzling central staircase crafted from bubinga with wenge and stainless steel accents. The artistic strokes of the brushed metal meld with the woodwork to create forms that mimic sea grass beds. This eclectic design is further emphasized in the dining salon that features an elegant bubinga dining table, with room for fourteen, and a majestic chandelier that is comprised of abstract botanical forms and brushed aluminum fronds frames.



ELEGANT, WITH A HINT OF WHIMSY
USHER'S PLAYFUL INTERIOR
INSPIRES **POLYNESIAN DREAMS**



WHILE HER **SLEEK LINES** AND IMPRESSIVE **MAXIMUM SPEED OF 24 KNOTS** EVOKE AN ADVENTURESOME DEMEANOR, USHER'S **LUXURIOUSLY DETAILED INTERIOR** INDUCES A SENSE OF LEISURE AND RELAXATION.





Master Suite

The master suite is an intimate oasis with walls of rich textured woodwork. High above the king-size bed with new MemoryFoam mattress, a glorious nautical-inspired stained glass oculus brings in resplendent natural light, yet can be screened at the touch of a button. Glass mosaic tiles provide a dramatic backdrop to the inviting hand-hammered copper soaking tub in the spacious en suite.





Guest Staterooms

The grand main staircase and elevator lead below to four spacious queen-size staterooms, two with Pullman berths. Luxuriously appointed and outfitted with all new linens, each stateroom features a new 46" flatscreen and the yacht's state-of-the-art audio/visual entertainment system controlled by personal mini iPads. All staterooms include private en suites, soundproof privacy doors, individual climate control and complete blackout on windows and portholes, affording a private cove of relaxation.



M/Y Usher | SPECIFICATIONS

DIMENSIONS

Length Overall: 46.94m (154')
Length Waterline: 42.14m (138'4")
Beam: 8.74m (28'8")
Draft (Max): 2.20m (7'1")
Gross Tonnage: 465

ACCOMMODATIONS

Guests: 10 + 2
Cabins: 1 x Master / 4 x Queen /
2 Pullman
Crew: 7

PERFORMANCE & CAPABILITIES

Speed (Max/Cruise): 24/20 knots
Range @ 12 knots: 3,500nm
Fuel Capacity: 55,965L (14,786USG)
Water Capacity: 7,861L (2,077USG)
Engines: 2 x MTU 16V 4000 M90

EQUIPMENT

Generators: 2 x Northern Lights 99kw
Stabilizer: Quantum
Thruster: 1 x Quantum
Air Conditioning: New Aqua Air

ENTERTAINMENT

Savant Sound system and library
New 46", 55" and 80" flatscreens
iPad Minis throughout

TENDERS & TOYS

Tenders: 56' Hampton (towed),
22' Novurania
Toys: Kayaks, fishing gear, flyrods,
wakeboard, inflatable paddle boards,
towable toys, 3-man inflatable couch,
snorkeling gear, underwater camera

CONSTRUCTION

Builder: Delta Marine, Seattle
Year/Refit: 2007/2014
Hull/Superstructure: Composite
Classification: ABS/AMS
Number of decks: 3
Elevator: Yes

DESIGN

Naval Architecture: Delta Design
Exterior Styling/Interior Design:
Juan-Carlos Espinosa, Delta Design



Deck Plans

AND COLOR KEY

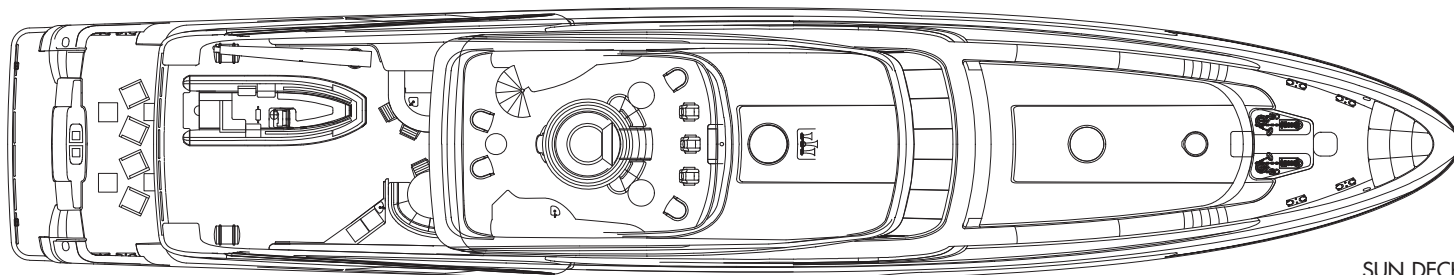

SUN DECK

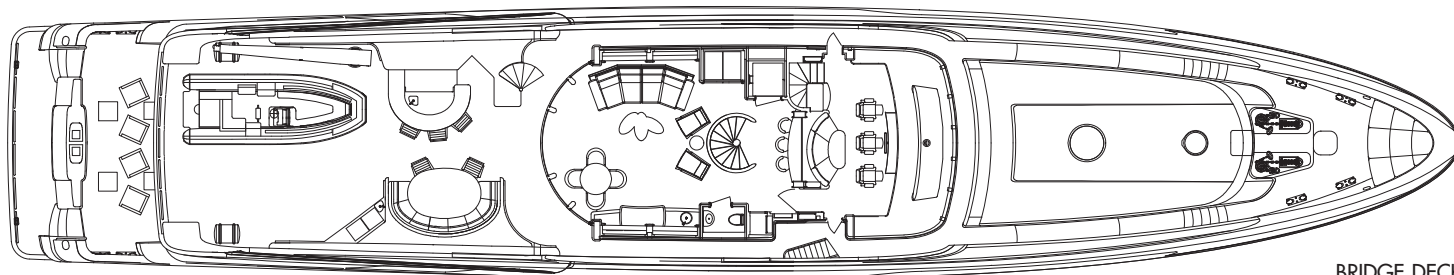

BRIDGE DECK

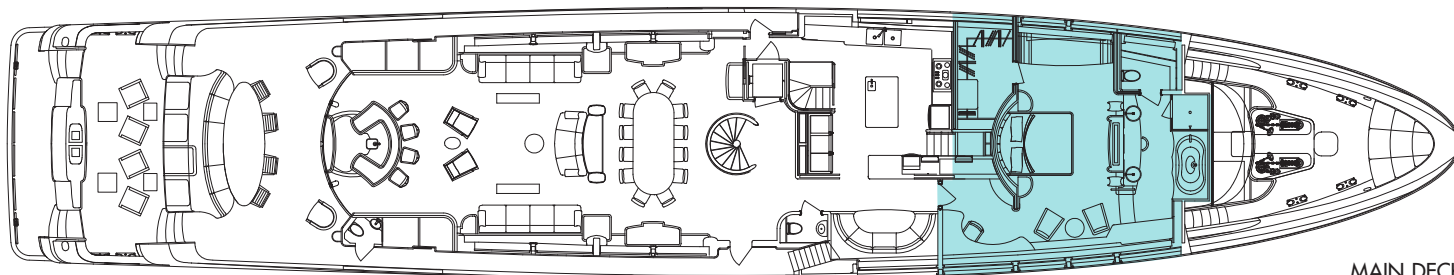

MAIN DECK

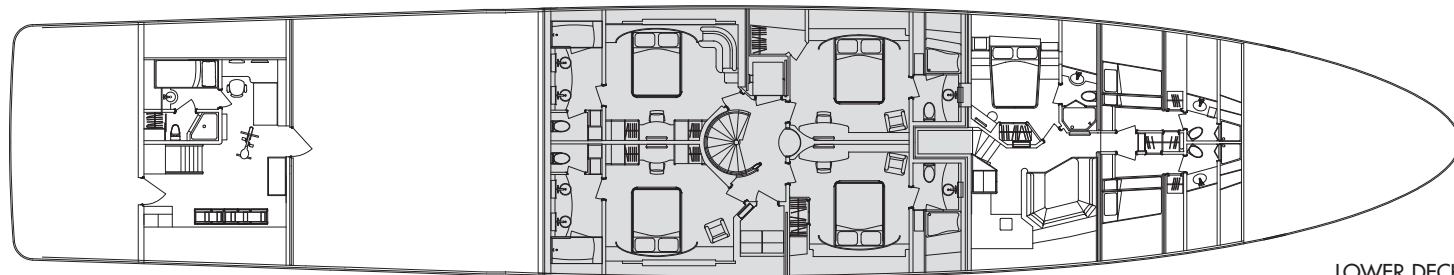

LOWER DECK

MASTER SUITE

GUEST STATEROOMS



Usher

Contact Your Charter Broker For More Information