

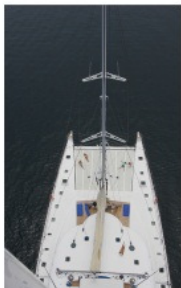



DOUCE FRANCE



Sleek, sophisticated, sexy and incredibly fast, this 138 ft catamaran, known as 'the gentle giant' is the largest in her category, and combines spaciousness, cleanliness, culinary excellence with the charms of a traditional sailing boat, the stability of a catamaran and the result of excellent design and construction by the world's finest craftsmen. Douce France is a famous charter yacht available in beautiful locations all over the world.



Douce France is a luxury sailing catamaran designed by Van Peteghem & Lauriot Prévost, world-renowned naval architects and specialists for multihull yachts. *Douce France* is perfectly equipped for charter worldwide to discover the world's most beautiful and unspoiled places whilst submerged in the highest standards of luxury in the yachting industry. She is built for adventure and graces the world seas with her gentle, yet impressive, appearance. Guests appreciate her spaciousness and intimacy, her elegance and fine line on the water. *Douce France* is unique and offers a guest experience that is unprecedented. With her 138 feet she's the largest schooner sailing catamaran in the world and anyone who sees her stunning looks cannot be left untouched. Guests have easy access to the sea and tenders with a fold away stairway. The aft deck is an exquisite sunbathing area or lends itself to cherish a perfect sunset over the infinite ocean. Her trampolines are exceedingly spacious, offering enough room for guests to sprawl out on and feel the sea spray as she glides along.



The teak decks are smooth and desirable to the touch and lure her guests to a variety of levels, including a towering fly bridge that embellishes the surroundings. A wet bar in the spacious cockpit offers guests a well-deserved refreshment in the shade after a swim. *Douce France's* beautiful interior is the essence of elegance. Furniture of Mahogany and Rosewood exudes a feel of colonial charm.



Douce France offers an environment that invites long naps and serenity in an abundance of comfortable outside settings where the natural scenery cradles the yacht. Guests have a choice of three dining areas. The spacious cockpit pleasantly shaded by the overhang of the deckhouse, the more intimate lounge for the cooler evenings or the aft deck where one can enjoy the warm breeze and dine under the starlight.



Snorkeling and diving are the greatest ways to discover underwater life. *Douce France* is equipped with all the necessary gear for any guest to dive into the crystal blue water and start discovering this captivating world. The onboard personal diving instructor will guide the guests into the tropical reefs and diving spots. With his great experience, guests will feel safe around their instructor while they are learning more about the fauna and flora below sea level. 8 full sets of diving gear are at the charterer's disposal.



What is more relaxing than having a massage on the fly bridge of *Douce France* with a 360-degree sea view around you? All you hear is the sound of the sea and the masseuse on board can take away any stress with her selection of different types of massages. *DOUCE FRANCE* also provides onboard all the necessary material for big or small game fishing. The crew will be happy to assist and instruct guests in the exciting sport of finding, hooking and reeling in one of the oceans predators.



An impressive selection of water toys and activities will please any guest. Peddling through the tropical blue waters in a one or two-seated ocean kayak, guests will discover their own little paradise of unspoiled nature and wildlife. *Douce France* has all the equipment to explore life below the waterline snorkelling around a reef or next to a white sanded beach.



For the more active guests, *Douce France* carries a large selection of water sports equipment and offers activities such as wave surfing, water-skiing, sailing and windsurfing. After workouts, guests can enjoy fresh fruit salads or healthy snacks created by the chef at all times during the day to recharge their batteries for the next adventure.



Aboard *Douce France*, barefoot charter guests dine alfresco. This wonderful experience leaves guests tasting the skills of the world-class chef while enjoying the view. Dining on *Douce France* is where one will appreciate the presence of French knowledge in the art of gastronomy. Masterful creations fresh from the sea are artfully presented on Limoges china and are enhanced by a wine selection that is perhaps one of the most extensive offered on board any charter vessel.



French haute cuisine as well as Asian, Japanese, Indian, Thai or Creole preparations with fresh fish and local ingredients will leave everyone not asking for more. Based on the client's preferences, the chef will personalize every meal. A professional crew will serve comfortably seated gourmets, the finest meals prepared in a modern stainless steel galley.



The boat is designed to accommodate 12 guests in 6 brightly lit and air conditioned staterooms. Each of them is attractively lined with pale sycamore wood. The chic linen beckons the guests to a restful night's sleep. Each 50 square feet room offers the option of either a queen double or twin single bed arrangement and also leaves sufficient room for a convertible desk or dressing table.



Every stateroom has its own spacious en-suite shower with a separate head compartment. After a sunny day on deck it is a nice feeling to get refreshed in the cooled rooms... *Douce France* just has all the requirements for a perfect holiday in secluded locations with a high standard of service and a welcoming crew.

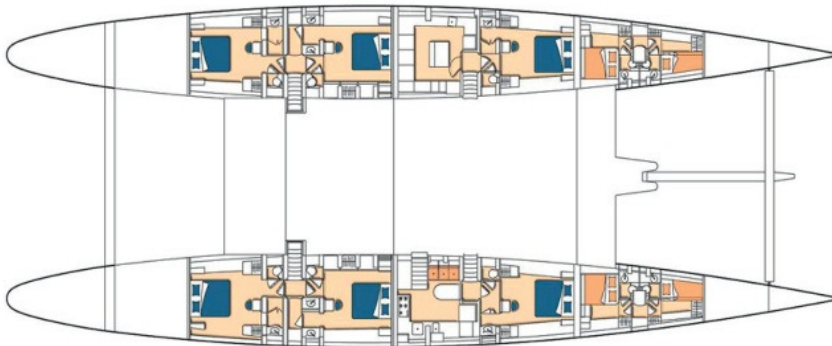
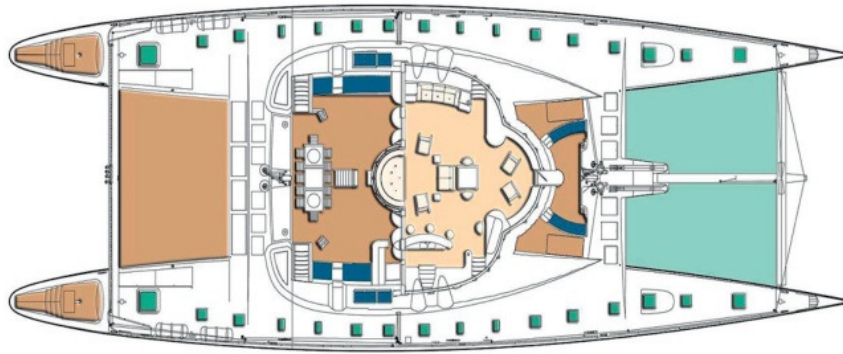
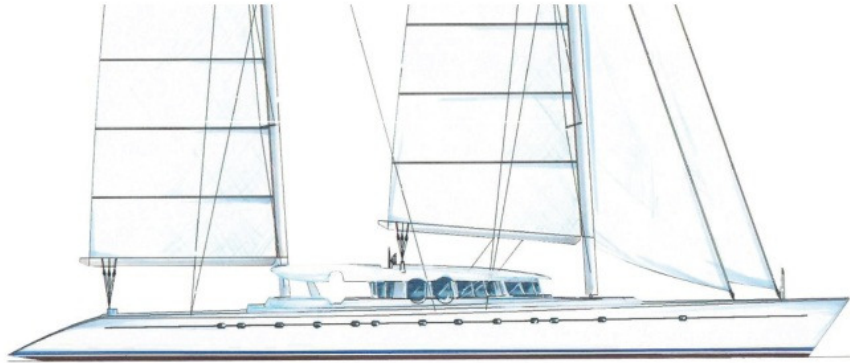

© VPLP - Alu Marine

Specifications:

Length:	42.2m – 138.5ft
Beam:	15.4m – 50.5ft
Draft:	2.5m – 8.2ft
Rig:	Two Masted Schooner
Built:	1998 - Refit:2008
Builder:	Alumarine - France
Naval Architect:	Van Peteghem & Lauriot Prévost
Hull construction:	Aluminium
Hull configuration:	Multihull
Displacement:	120t
GT:	218t
Cruising speed:	9.5 kts/h
Sailing speed max:	18 kts/h
Fuel consumption:	2x25 l/h
Range:	3500NM
Flag:	Belgian
Port of Registry:	Antwerp
	Commercial Vessel

Accommodation:

Number of cabins:	6 – convertible twin or queen double
Total guests:	12 passengers
Total crew:	7
Air-conditioning:	throughout the accommodation and cabins

Equipment:

Main Engines:	2x Nannidiesel 306hp
Generators:	2x 80kW Cummins 6BT5.9D (M) + 1x Northern Lights 80kW + Emergency generator
Watermaker:	2x 10.000/d HEM – Dessalator – 440l/hr
Air Compressor:	Bauer 40sqf/h

Main sail Area:	206m ² - 675sqft
Main foresail:	185m ² - 607sqft
Yankee:	138m ² - 452.7sqft
Staysail:	80m ² - 262.5sqft
Storm jib:	20m ² - 65.6sqft
Genaker:	235m ² - 770sqft
Genaker Main mast:	245m ² - 804sqft

Watertoys:

Main Tender:	6.5m Zeplin RIB – 150hp Yamaha
Crew Tender:	4.1m - 21ft Cholamark Rib - 40hp Yamaha
Diving gear:	8 full sets – aluminum bottles
Snorkeling gear:	15 full sets + Wetsuits
Water-ski:	children, adult, slalom, acrobatics and Wakeboard
Other Toys:	2 x Laser Radial Small Sailing Dinghy
	4x Sea Kayaks
	Windsurf
	Long board surfboard
	Donuts
	Flying Manta
	Professional Fishing gear - big and small game



DOUCE FRANCE