

# INDIGO STAR I

*38m Star & Moschini*



**FOR CHARTER - 2020**

# INDIGO STAR I

*38m Star & Moschini*



*Built 1995, refit 2018*

# INDIGO STAR I

*38m Star & Moschini*



*10 guests, 5 staterooms, 7 crew*

# INDIGO STAR I

38m Star & Moschini



*Comfortable and spacious deck seating areas*

# INDIGO STAR I

*38m Star & Moschini*



*Deck Dining*

# INDIGO STAR I

38m Star & Moschini



*Contemporary & sophisticated living areas*

# INDIGO STAR I

38m Star & Moschini



*Contemporary & sophisticated living areas*

# INDIGO STAR I

38m Star & Moschini



*Contemporary & sophisticated living areas*



# INDIGO STAR I

*38m Star & Moschini*



*Contemporary & sophisticated living areas*

# INDIGO STAR I

38m Star & Moschini



*Contemporary & sophisticated living areas*

# INDIGO STAR I

38m Star & Moschini



*Open plan main salon with dining room*

# INDIGO STAR I

38m Star & Moschini



*Dining Room*

# INDIGO STAR I

38m Star & Moschini



*Master Stateroom*

# INDIGO STAR I

38m Star & Moschini



*Master Office*

# INDIGO STAR I

38m Star & Moschini



*Master Bathroom*

# INDIGO STAR I

38m Star & Moschini



*Double Stateroom*



# INDIGO STAR I

38m Star & Moschini



*Double Stateroom*

# INDIGO STAR I

*38m Star & Moschini*



*Twin Stateroom*

# INDIGO STAR I

38m Star & Moschini

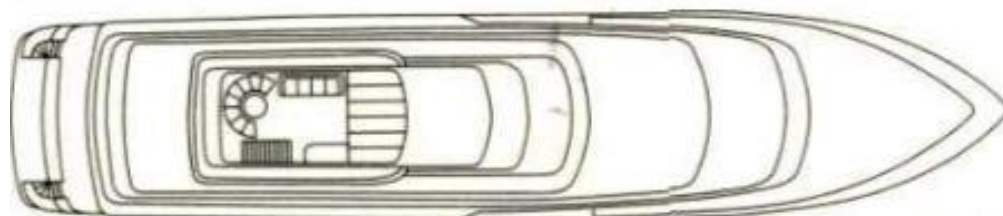

Sun deck

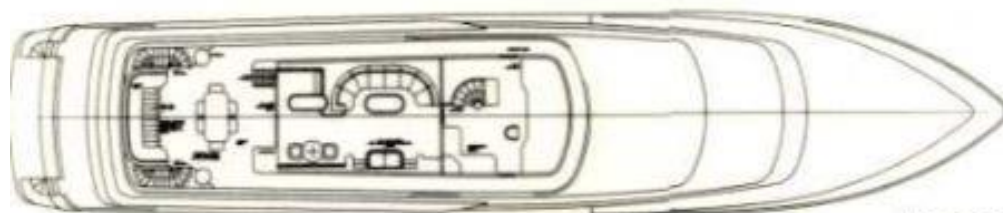

Upper deck

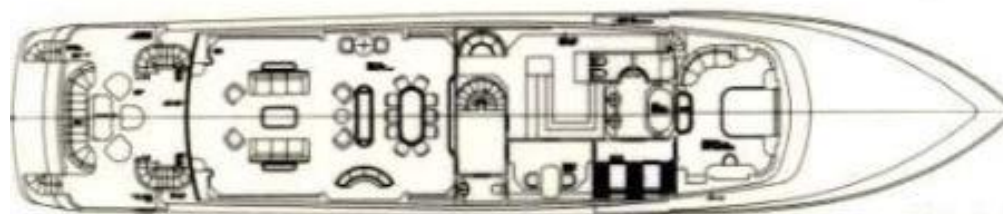

Main deck

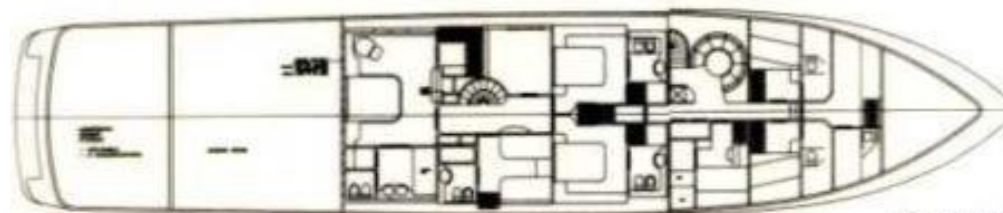

Lower deck

*Deck Plans*

# INDIGO STAR I

38m Siar & Moschini



**Captain plus 6 crew**

**10 guests in 4 double cabins & 1 twin cabin**

Weekly Charter Rates – MYBA Terms

**€ 88,000/week – High Season**

**€ 77,000/week – Low Season**

**Length:** 38.00m (124' 8")

**Beam:** 7.70m (25' 3")

**Draft:** 2.70m (8' 10")

**Year built:** 1995 (refit 2018)

**Builder:** Siar & Moschini

**Interior Designer:** Siar & Moschini

**Naval architect:** Siar & Moschini

**Hull Construction:** GRP

**Hull Configuration:** Semi displacement

**Consumption:** 600 Litres /Hr

**Cruising Speed:** 14 knots

**Flag:** Maltese



**Engines:** 2 x MTU, 2.285 HP

**Generators:** 2 x Northern Lights 78 KW, 1 x Kohler 25 KW

**Stabilizers:** 2 x SEAKEEPER 35

**Tenders & Toys:**

- Zodiac tender YL470DL SHARC RIB white with 100 HP Yamaha
- Jet ski Seadoo rotax 4-TEC with 260 HP
- Fly board with jetski control
- Inflatable water slide
- Combi, children and slalom waterskis
- Wakeboard
- 3 x Seabobs
- 5 x Aqualung diving sets
- 2 x Doughnuts and banana
- Chase Boat Sillinger, length 9.05 m, width 3,05 m, Mercury Verado engines 2 x 250 hp (available on request and at surcharge of EUR 500 per day plus VAT).