



# PEGASUS

**Length:** 53.00 metres (173' 11")

**Beam:** 9.70 metres (31' 10")

**Draft:** 3.5 metres (11' 6")

**Number of Guests:** 12

**Number of Crew:** 13

**Built:** 1997

**Refit:** 2009

**Builder:** Feadship

**Naval Architect:** De Voogt

**Flag:** Greek

**Hull Construction:** Steel

**Hull Configuration:** Displacement

Air conditioning, Deck Jacuzzi, Gym/exercise equipment,  
Stabilisers at anchor, Stabilisers underway, WiFi connection on  
board

# KEY FEATURES

- 1** Refitted from scratch at Feadship in 2009
- 2** Immaculate condition
- 3** Jacuzzi & plunge pool at sundeck
- 4** Fully equipped gym
- 5** Beach club





Pegasus Aerial View



Pegasus Cruising 1



Sun Deck



Sun Deck deck Aft





Sun Deck Plunge Pool 1



Sun Deck Plunge Pool 2



Sun Deck Jacuzzi 1



Sun Deck Jacuzzi 2





Upper Deck Aft 1



Upper Deck Aft 2



Main Deck Aft



Gym on Sundeck





Upper Deck Salon 1



Upper Deck Salon 2



Upper Deck Salon 3



Upper Deck Salon 4





Main Deck Salon 1



Main Deck Salon 2



Main Deck Dining Area



Master Suite 1





Master Suite 2



Master Study



Master Bath TV



VIP Suite





VIP II Suite



Twin I Stateroom 2



Twin II Stateroom 1



Twin II Stateroom 2





Twin Stateroom Bath



Beach Club



Water Toys 2



Water Toys 3

# SPECIFICATIONS

## ACCOMMODATION

**Number of Guests:** 12

**Number of Cabins:** 6

**Cabin Configuration:** 3 Double, 3 Twin

**Bed Configuration:** 3 Pullman, 1 King, 2 Queen, 6 Single

## EQUIPMENT

**Engines:** Engines: 2 x 2800 BHP - Cat 3516 DI-TA

**Generators:** 2 x 125 kW Cat

**Cruising Speed:** 14 knots

**Fuel Consumption:** 390 Litres/Hr

## WATERSPORTS

**Tenders + Toys:** 1 x 8.8m Air Ship 250 HP engine (12 persons)

1 x 4.6m Nautica RIB 70 HP engine (5-6 persons)

1 x Jet Ski Kawasaki Ultra 250 HP engine

1 x Kawasaki Stand Up Jet Ski 80 HP engine

1 x Seadoo Jet Ski Two Seats 280 HP engine

1 x Sea-Doo Aqua Lounge 6 Inflatable With MP3 System

3 x Giant Towable Inflatable

1 x Double Trouble Towable Inflatable

1 x EZ Ski Trainer

1 x Ski Trainer

1 x Jumbo Hotdog Inflatable (Seating 5 Riders)

2 x Waveboards

1 x Wakeboard

2 x Stand-up Paddle - Board ( SUP, ALLROUND 11,8') with Paddle Bamboo Carbon 40%

1 x Gladiator (Seating 4 Riders)

1 x Tarik inflatable SUP

1 x Nautiboy platform

2 x Schiller bikes

Complete Water Ski Sets:

### ADULTS

1 set x Double Skis for beginners

1 set x Double Skis

1 set x Slalom Skis for beginners

1 set x Slalom Skis

### CHILDREN SKIS

2 sets x Double Skis for beginners

1 set x Double Skis

Complete Scuba Diving Equipment for six people

Snorkeling Equipment

Fishing Equipment

Swimming Platform

BEACH CLUB inches from the ocean



# LAYOUT

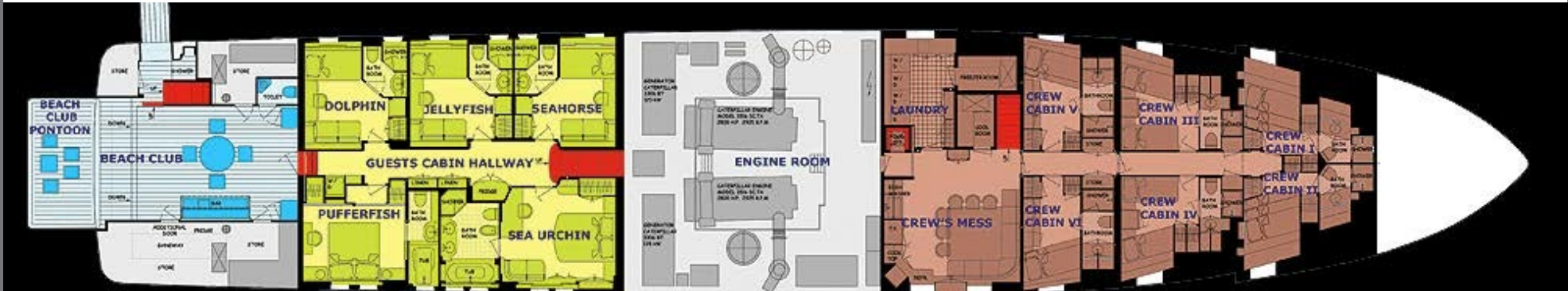

## **Disclaimer**

This document is not contractual. All specifications are given in good faith and offered for informational purposes only. The publisher and company do not warrant or assume any legal liability or responsibility for the accuracy, completeness, or usefulness of any information and/or images displayed. Yacht inventory, specifications and charter prices are subject to change without prior notice. None of the text and/or images used in this brochure may be reproduced without written consent from the publisher.