



MARIU

Length: 49.90 metres (163' 9")

Beam: 9.50 metres (31' 2")

Draft: 3.4 metres (11' 2")

Number of Guests: 12

Number of Crew: 11

Built: 2003

Builder: Codecasa

Flag: Maltese

Hull Construction: Steel

Hull Configuration: Semi displacement

Air conditioning, Approved RYA water sports centre, Deck Jacuzzi, Elevator/lift, Gym/exercise equipment, Stabilisers at anchor, Stabilisers underway, WiFi connection on board

Designed by and built for iconic fashion designer Giorgio Armani, MARIU is the height of fashion. Textures and tones found onboard include leather, richly grained woods and aluminium ceilings that have a soft reflective sheen, beautifully contrasting the rustic wide teak floorboards and bleached oak panelling.

With open-plan saloons and minimalist staterooms, MARIU has six well-appointed double cabins. The yacht is ideally set up for families and friends charters. An elevator connects all four decks, including a very large sun deck that can be flexibly

shaded for sunbathing or an afternoon nap. The Jacuzzi that is found forward on the sun deck is the ideal place to enjoy sundowners. The main deck office has recently been replaced with a 200-bottle wine cellar allowing guests to enjoy a large variety of refined wines.

Armani's ideas and vision have leapt from catwalk to cakewalk. Here is the chance to charter the lifestyle. MARIU is now an RYA training establishment for personal water craft and her vast array of water sports will impress even the most active guests.

KEY FEATURES

- 1** Armani designed yacht
- 2** Spacious, contemporary and sleek interior
- 3** 6 double cabins with 5 king size beds
- 4** Maintained every winter to the highest standards
- 5** Phenomenal list of toys
- 6** Jacuzzi on the sundeck
- 7** Gym equipment on the sundeck
- 8** Highly referenced and knowledgeable Captain



Sundeck



Sundeck with Awning



Sundeck



MARIU Platforms



Double Guest Cabin



Master Cabin



Main Salon



Guest Ensuite



Flyboard



Kitesurfing



Stand Up Paddle Boards



MARIU

SPECIFICATIONS

ACCOMMODATION

Number of Guests: 12

Number of Cabins: 6

Cabin Configuration: 6 Double

Bed Configuration: 2 Pullman, 5 King, 1 Queen

EQUIPMENT

Engines: Engines: 2 Caterpillar 3516B 2,260HP each
Generators: 2 Northern Lights 380V 50 hZ 125 kw @ 322
gpd/ 1219 lpd ea; 1 x Emergency generator Northern
Lights 5,0kW

Water capacity: 19,340 ltrs

Fuel capacity: 120,000 ltr

Quanto zero speed stabilizers

Range: 46000 nm at 14 knots

Eco speed 12 knots @ 320 l/p

Cruising Speed: 14 knots

Fuel Consumption: 620 Litres/Hr

WATERSPORTS

Tenders + Toys: TENDERS:

RIB 9.5m 2008 Novurania chase tender (Overhauled in
2011) (Full refit 2017)

RIB 4m Castoldi jet tender (overhauled in 2017)

WATER-TOYS:

- 1x Seadoo RXP 255
- 1 x Yamaha Wave runner 1800
- 1 x Seabob Cayago F5
- 1 x Fly board Legend (2015)
- 1 x Jet pack (2015)
- 1 x Kneeboard
- 1 x Bodyboard
- 3 x Wakeboard (O'Brian Coda 129cm, Jstar Titan
141cm, Jstar Region 141cm)
- 1 x Wakesurf Liquid Force (2015)
- 2 x Kiteboard (RRDesign Placebo 134x41,
Underground 132x41)
- 2 x Kitesurfing Kite (RRD Passion 13m, RRD Obsession
7m)
- 3 x Waterskies (pairs) (Jobe Sixtyseven, Subject,
Hydroslide 138cm)
- 1 x Monoskies Jobe 68/69
- 1 x Windsurf board Naked 128
- 2 x Windsurf sails (5m and 6m)
- 2 x Starboard Paddleboard AST 11'2 (2015)
- 1 x 2 person rigid kayak (2016)
- 2 x 1 person rigid kayak (2016)
- 1 x Towable Banana 6 pax
- 1 x Towable XO Extreme 3 pax
- 1 x Towable Airstream III 3 pax
- 2 x Towable Jobe children doughnuts
- 2 x Sets of Game fishing rods
- 12 x Sets of Snorkeling gear
- 6 x full sets of Diving equipment - (RDV Diving only)
- 1 x Dive compressor
- 4 x Mountain bikes
- 1 x JetSurf Factory GP Green (2018)

GYM EQUIPMENT (on sundeck):

Swiss balls

- Balance disk
- Dumbbells 1kg, 2kg, 3kg, 4kg
- Kettlebells 8kg
- Skipping ropes

LAYOUT

MARIU - GA

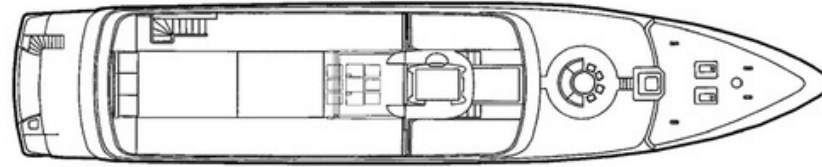

SUN DECK

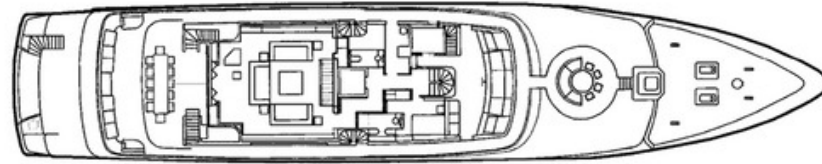

BRIDGE DECK

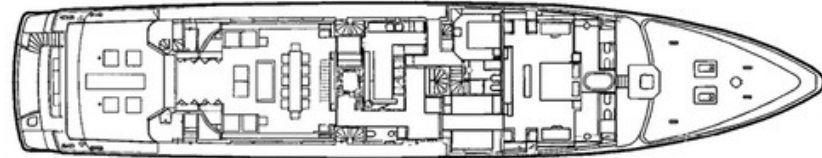

MAIN DECK

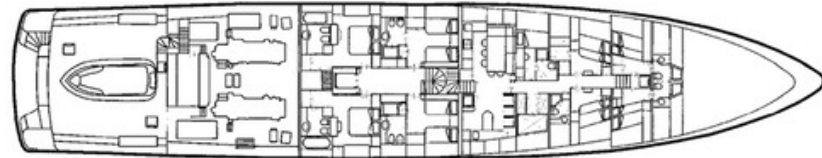

LOWER DECK

Disclaimer

This document is not contractual. All specifications are given in good faith and offered for informational purposes only. The publisher and company do not warrant or assume any legal liability or responsibility for the accuracy, completeness, or usefulness of any information and/or images displayed. Yacht inventory, specifications and charter prices are subject to change without prior notice. None of the text and/or images used in this brochure may be reproduced without written consent from the publisher.